

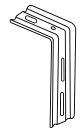

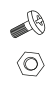



avanat Instructions Installation

Sheer shade

Toile attournée

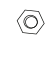
< 40 po		2X		2X		2X		4X
> 44 po		3X		3X		3X		6X

Les composantes réelles peuvent différer légèrement des illustrations

Actual components may vary slightly from the illustrations

1a À l'intérieur du cadre OU au plafond.
Inside mount / Inside window frame.

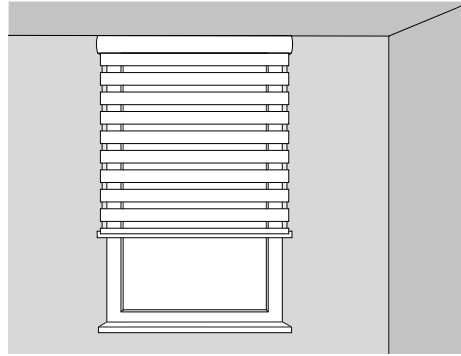
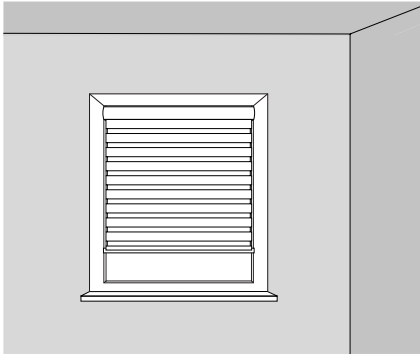

1b À l'extérieur du cadre.
Outside mount / Outside window frame.

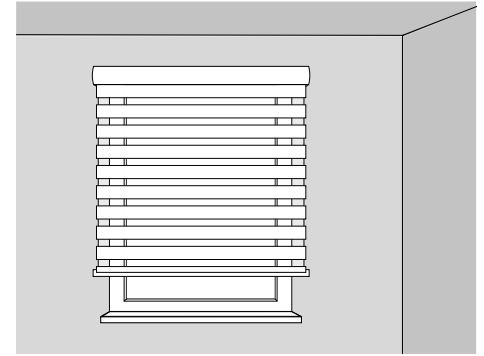

2a Utiliser un seul support d'installation.
Use only bracket, screw to frame or ceiling.

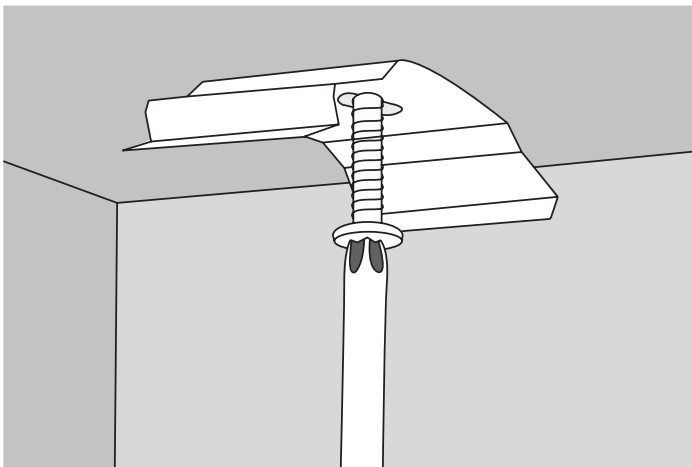

2b Utiliser les 2 supports, joints avec l'écrou et le boulon.
Clamp both brackets using screwbolt & nut, and screw to wall.

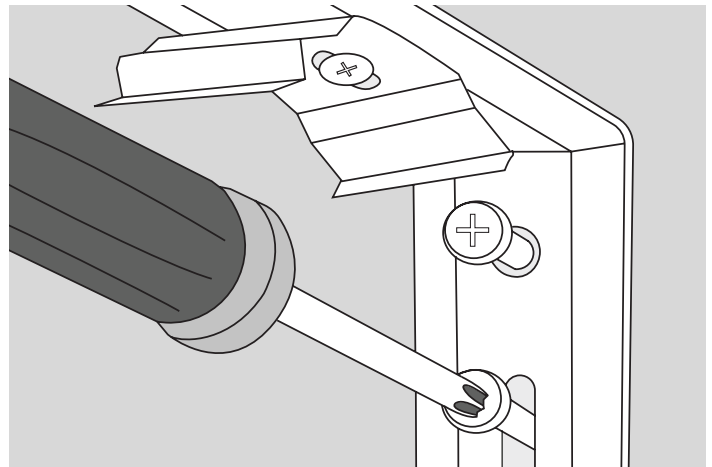

3 Cliquez le caisson d'aluminium dans le support.
Clip the head rail in the mounting bracket.

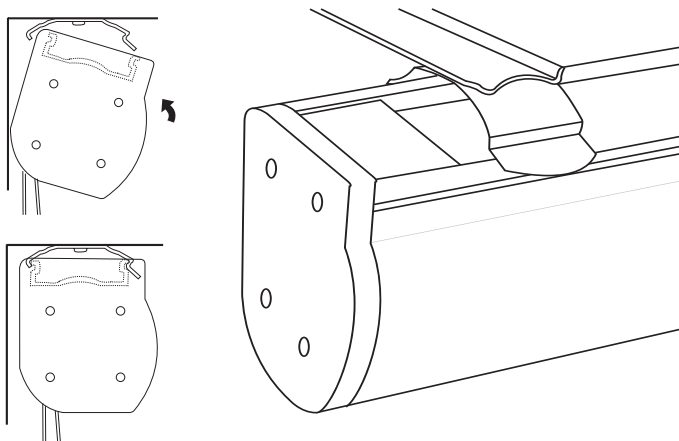

Pour relever la toile plus facilement, utiliser vos deux mains et poussez doucement.



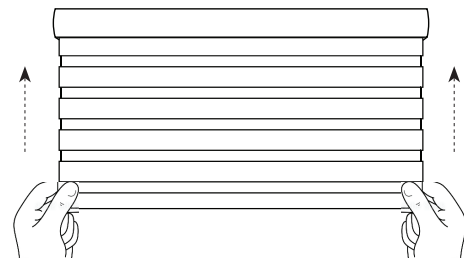



To raise the shade more easily, use both hands and push slowly.

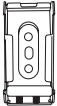

avanat Instructions Installation

Blackout Shade

Toile opaque

< 40 po		2X		2X		2X
> 44 po		3X		3X		3X

Les composantes réelles peuvent différer légèrement des illustrations

Actual components may vary slightly from the illustrations

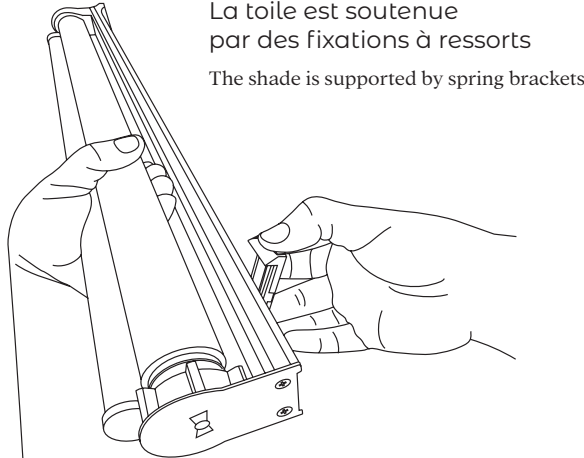

La toile est soutenue par des fixations à ressorts
The shade is supported by spring brackets

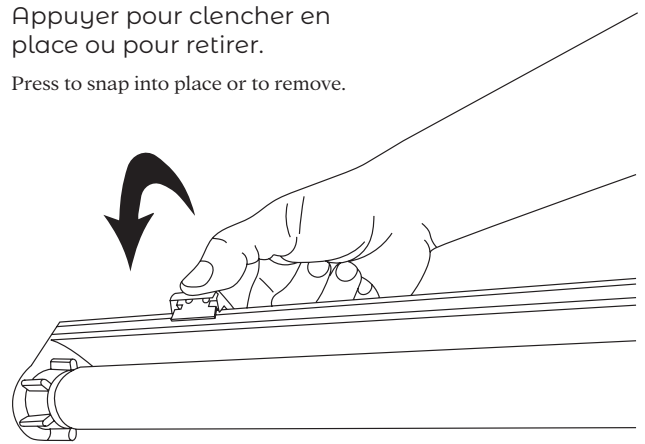

Appuyer pour clencher en place ou pour retirer.
Press to snap into place or to remove.

1a À l'intérieur du cadre.
Inside mount / Inside window frame.

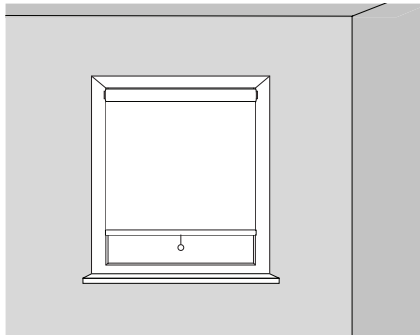

1b Au plafond.
Ceiling mount.

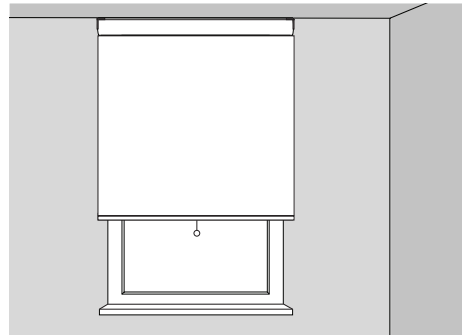

1c À l'extérieur / sur mur ou cadre.
Outside mount / Outside window frame.

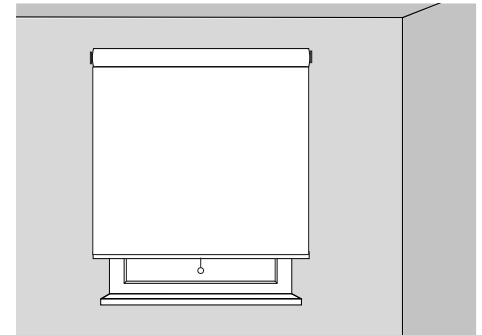

2a **2b** Installer les fixations au haut du cadre ou au plafond, à l'horizontal.
Install the brackets at the top of the frame or on the ceiling, horizontally.

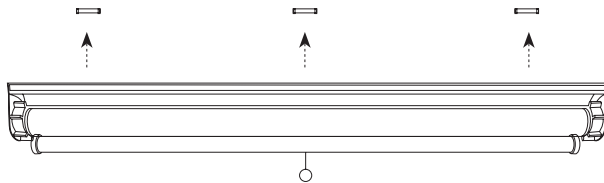

2c Installer les fixations au mur ou sur le cadre, à la verticale.
Install the brackets on the wall or on the frame, vertically.

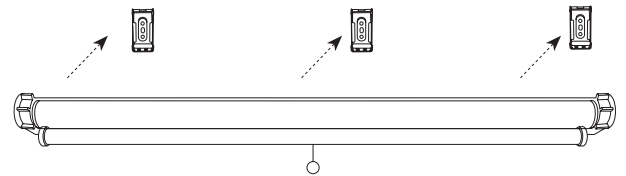

Ajuster la tension.

Tourner la roulette vers l'avant pour augmenter et vers l'arrière pour diminuer.

Adjust power of spring.
Rotate the wheel forward to increase.
Rotate backward to decrease.

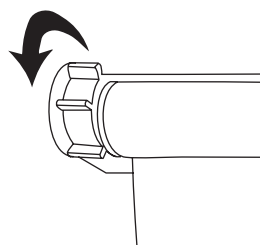

Ajuster la retombée de la base.

Tourner vers l'avant pour remonter et vers l'arrière pour descendre.

La longueur idéale sera différente pour une installation intérieure ou extérieure.

Rotate forward to bring up and backward to bring down.
The ideal length will be different for inside or outside mount.

